

Model NO	D-313SE-MATX
Ext	5.25"x2+3.5"x1
Hid	3.5"x4
M/B	9.6"x9.6"
Fan	12CMx1+8CMx1+6CMx2 (Option)
Slot	4
Rev	

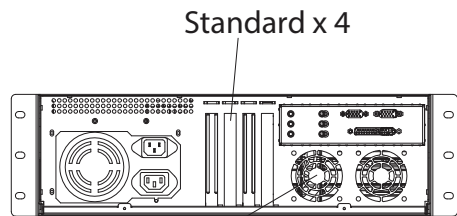

6.0cm Fan x 2(optional) 9.6" x 9.6" MATX

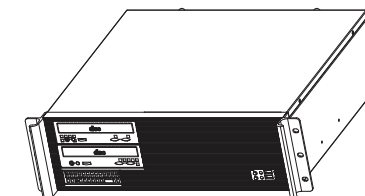
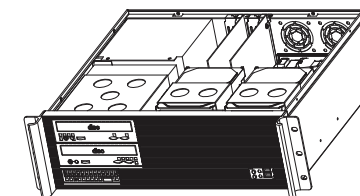
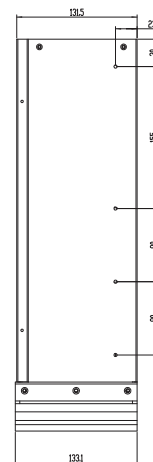
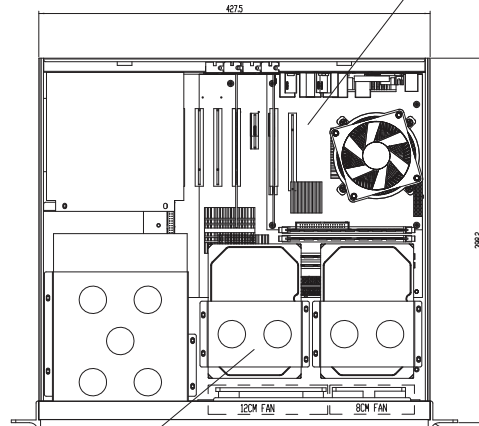
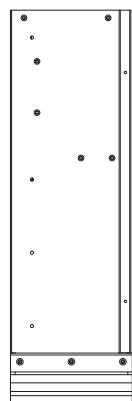

3.5" HDD x 4

5.25" Bay x 2

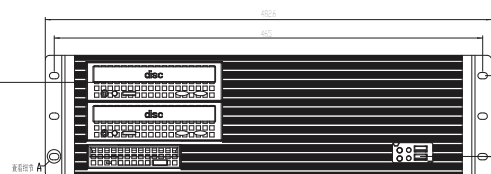

USB2.0 x 2

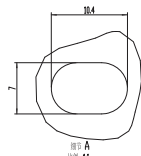

3.5" Bay x 1

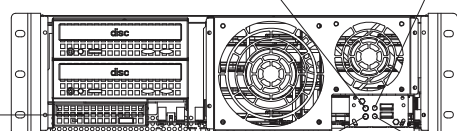

Power switch Power LED

Reset HDD LED

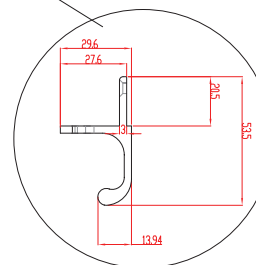

**NOTE:**

1. 材质要求环保 (RoHS) ;
2. 机箱外表面粉烤黑色。

DATE	SSCC FILE	REV	AD	IN	BY	CHK	APP
FINISH	SEE NOTE	1-4	JA	JA	JA	JA	MEET
DRAWN	Revise No.	14-03-06	6-10	JA	JA	JA	SCALE
DESIGN	Revise No.	14-03-06	30-03	JA	JA	JA	REVISE No.
CHECKED	---	---	---	JA	JA	JA	FILE No.
APPROVED	---	---	180-025	JA	JA	JA	PART No.